

# Installation Manual

## 6" Angle Series - Top of Pole Mount

844-MT-SOLAR (687-6527)  
[www.mtsolar.us](http://www.mtsolar.us)





Thank you for choosing MT Solar Pole Mounts.

It is the installer's responsibility to determine foundation parameters based on local site conditions, such as wind speed, snow load, soil type, exposure category, etc. Installations also must comply with local building regulations and requirements.

We recommend consulting an engineer for a recommendation on foundation dimensions and pipe size and thickness. MT Solar can also provide a stamped drawing engineered for site-specific requirements for an additional fee. Please contact us to find out more.

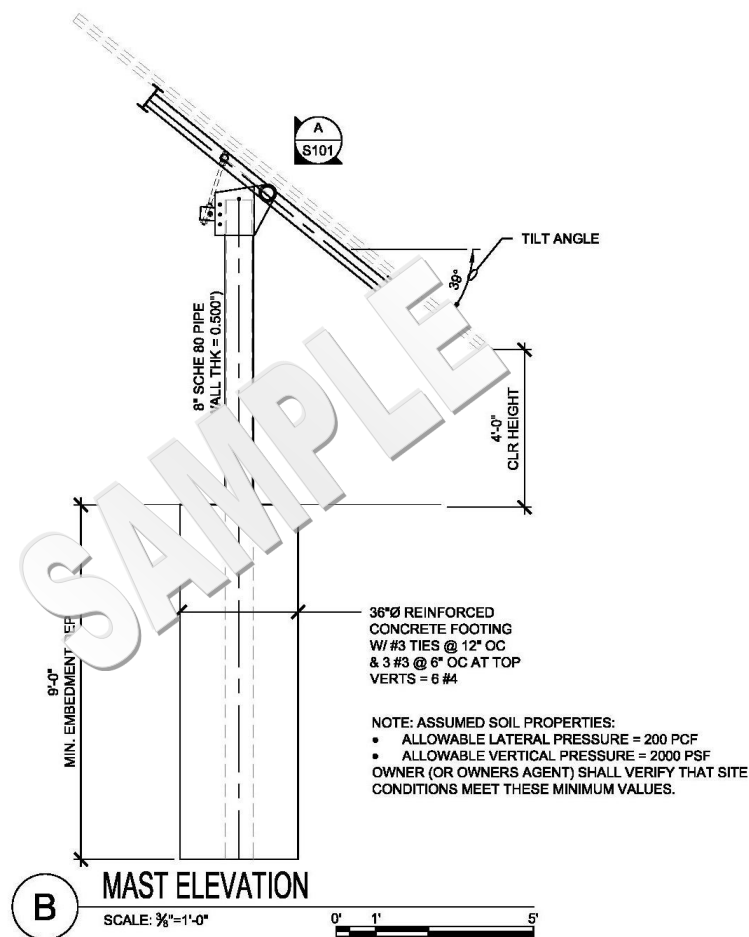

### Tips for Conventional Pipe Installation:

- Dig hole according to recommended depth and diameter.
- Set pipe in hole and use a level to ensure it is plumb and vertical to the ground.
- If installing multiple poles, use a string to line up pipes.
- Brace pipe to prevent it from moving while pouring concrete.
- Proper compaction of backfill around sonotube or form is recommended, unless pouring so that concrete is in direct contact with the soil.
- Allow concrete to cure for recommended length of time.

# 6" Series TPM Components— Exploded View

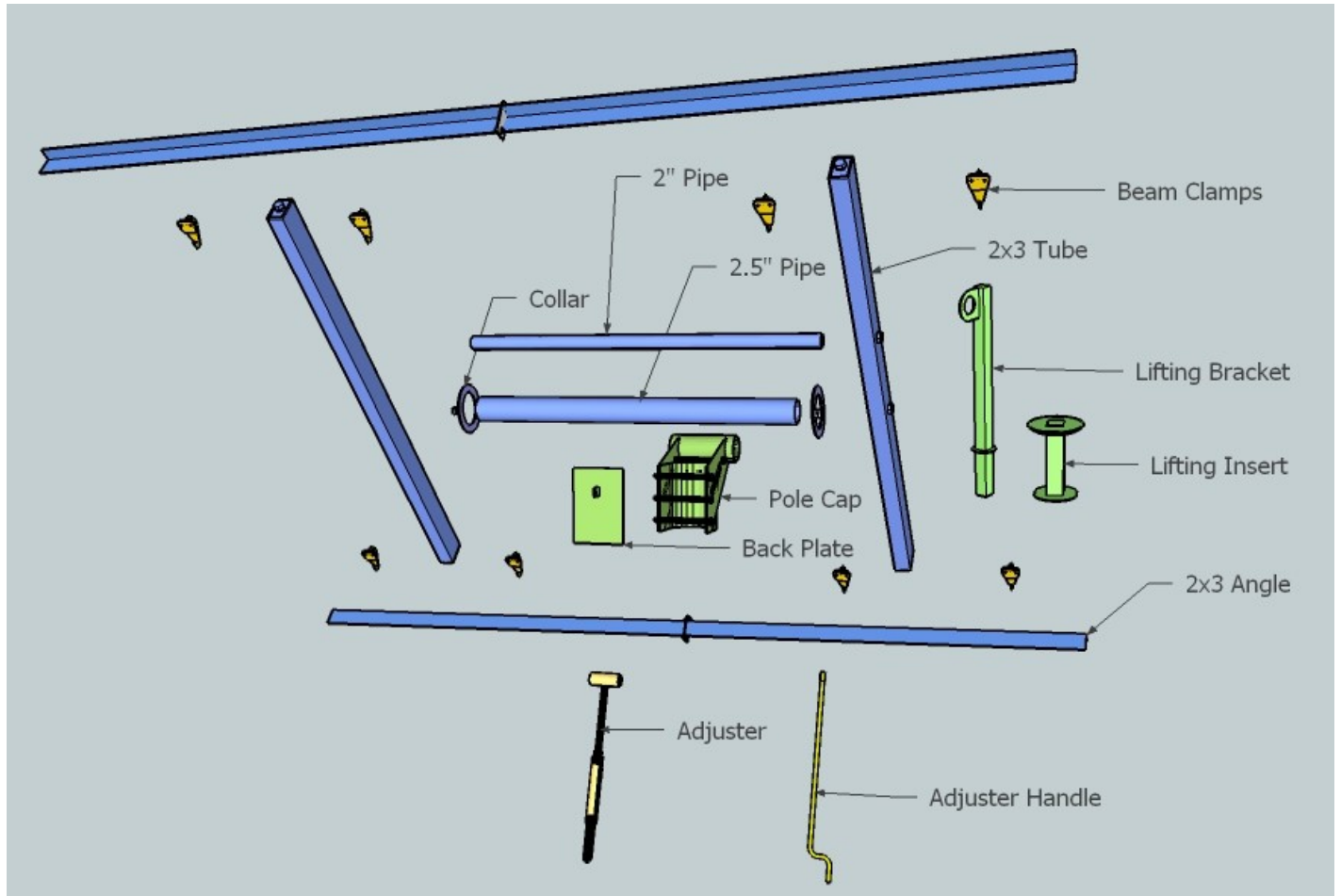

## Components List:

Qty	Description
4	3x2 Angle
2	2x3 Tube
1	2.5" Pipe
1	2" Pipe
1	U Bracket / Pole Cap
1	Adjuster
1	Adjuster Handle
1	Back Plate
8	Beam Clamps
2	Locking Collar
1	Lifting Bracket
1	Lifting Insert
4	3/4"x9" Bolts
4	3/4" Nuts
8	3/4" Flat Washers

Qty	Description
2	3/4"x3" Square Head Bolts
3	1/2"x1" Square Head Bolts
1	1/2"x1 1/2" Bolt
2	1/2" Flat Washers
1	1/2" Nylon Lock Nut
4	1/2"x3 1/2" Bolts
8	1/2" Flat Washers
8	1/2" Split Washers
4	1/2"x1 1/2" Bolts
4	1/2"x1 1/4" Bolts
4	1/2"x1 1/4 Flange Nuts
**	3/8"x1 1/4" Carriage Bolts
**	3/8" Flange Nuts
**	3/8"x1" Stainless Bolts
**	3/8" Serrated Flange Nuts

## Tools Required:

- 1 1/8" Socket
- 3/4" Socket
- 9/16" Socket
- Crescent Wrench
- Torque Wrench
- Tape Measure
- Angle Finder
- Compass
- Ladder

\*\* Varies depending on the number, size and layout of modules.

See packing list for Quantity.

# Installation Guide

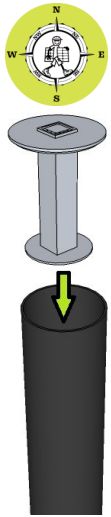

101



102

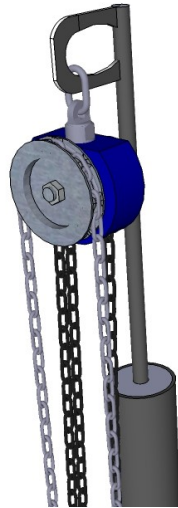

103

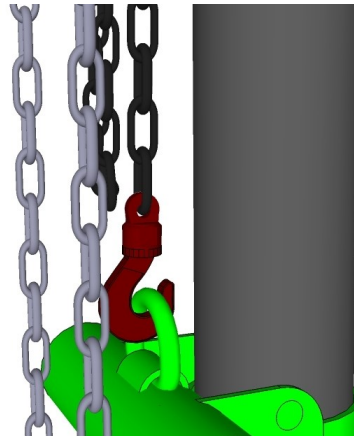

104 A



104 B

101: With the 6 Inch steel support pole installed in the ground, orient the compass to the north and place the lifting insert into the pole until it sits flush with the top.

102: Place the lifting bracket into the lifting insert with the eye facing south.

103: Hang a 1 ton or greater chain fall hoist from the lifting eye.

104: Hang the U-Bracket Assembly on the Chain Hoist.

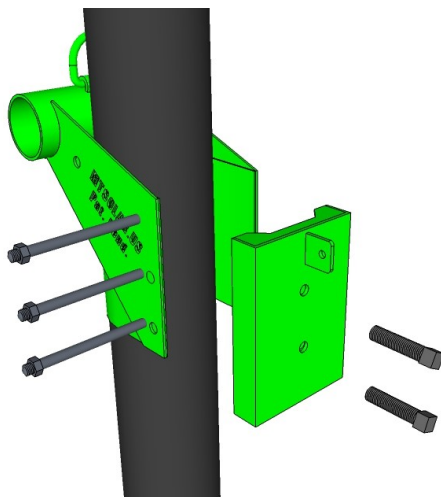

105

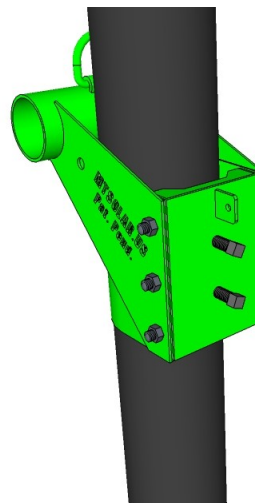

106

105: While holding the U-Bracket around the pole, insert 3 of the 3/4" x 9" bolts through the holes in the back of the U-bracket and through the holes on the Back Plate with 3/4" flat washers on both sides and 3/4" nuts.

106: Insert the 3/4" x 3" Set Bolts in Back Plate, but do not tighten if leaving chain fall hoist connected.

Note: If installing multiple mounts with a single hoist, bolt the pole cap on the pole at the desired working height. Tighten 3/4" bolts and 3/4" set screws to 200 ft-lb. Assemble rack, rails and modules. Then, move lifting assembly and hoist to pole when ready to lift. Attach to pole cap and loosen bolts. Continue with raising the array for wiring or completing the installation.

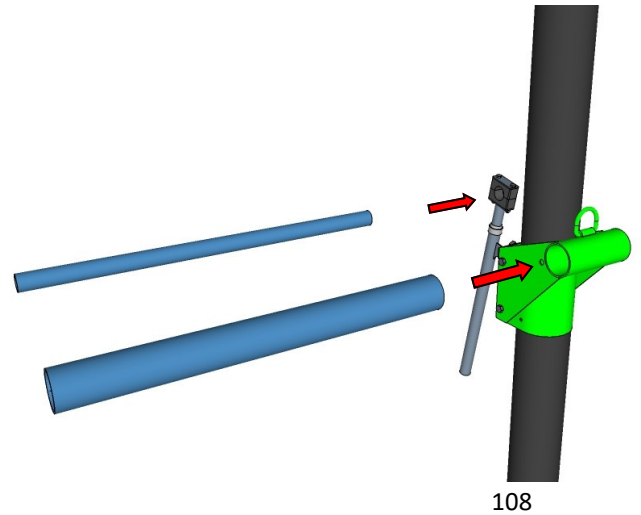
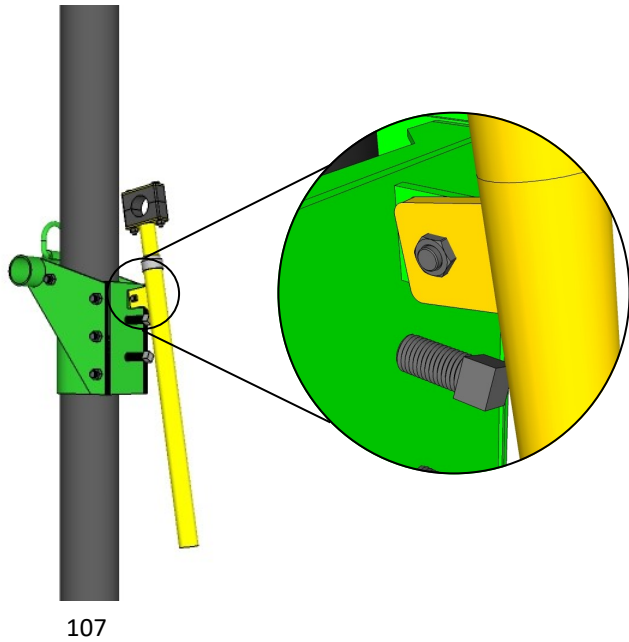

107: Attach the Screw Adjuster to the tab on the Back Plate with the 1/2" x 1 1/2" Bolt, two 1/2" flat washers and 1/2" Nylock Nut.

108: Slide the 2" pipe through the screw adjuster clamps and slide the 2.5" pipe through the U Bracket Assembly sleeve.

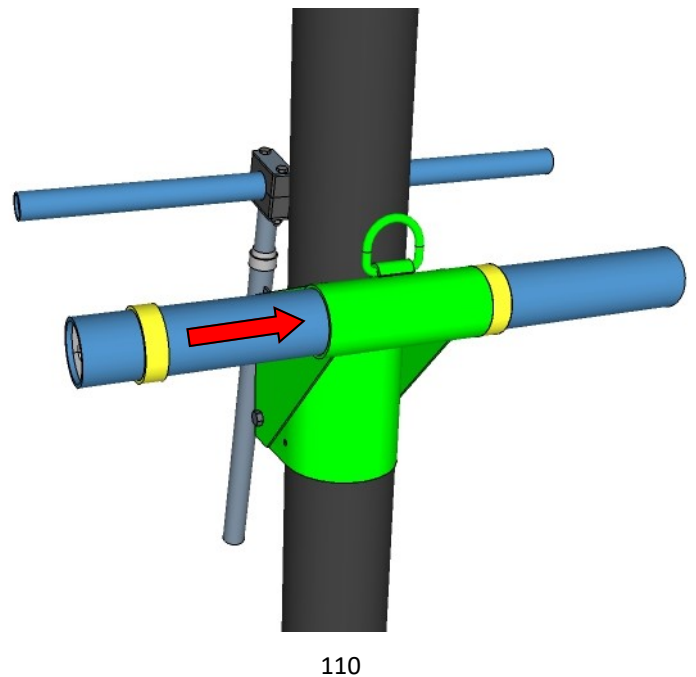
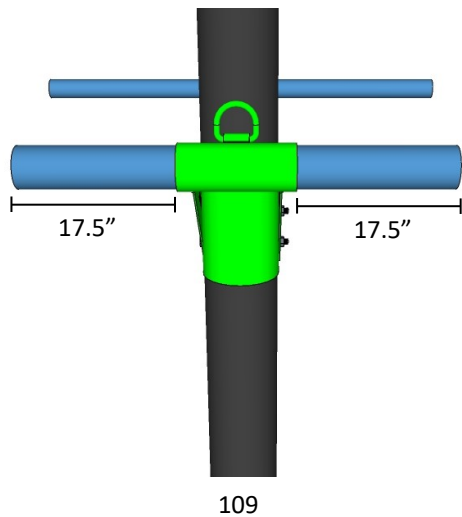

109: Center pipes in sleeves. There should be approximately 17.5" of the 2.5" pipe on either side of the sleeve.

110: Slide collars on 2.5" pipe and tighten with 1/2" x 1" square head set bolts. Hold collar firm against the sleeve when tightening. Insert 1/2" x 4 3/4" bolts in the screw adjuster clamp around the 2 inch pipe and tighten to 20 ft. lbs.

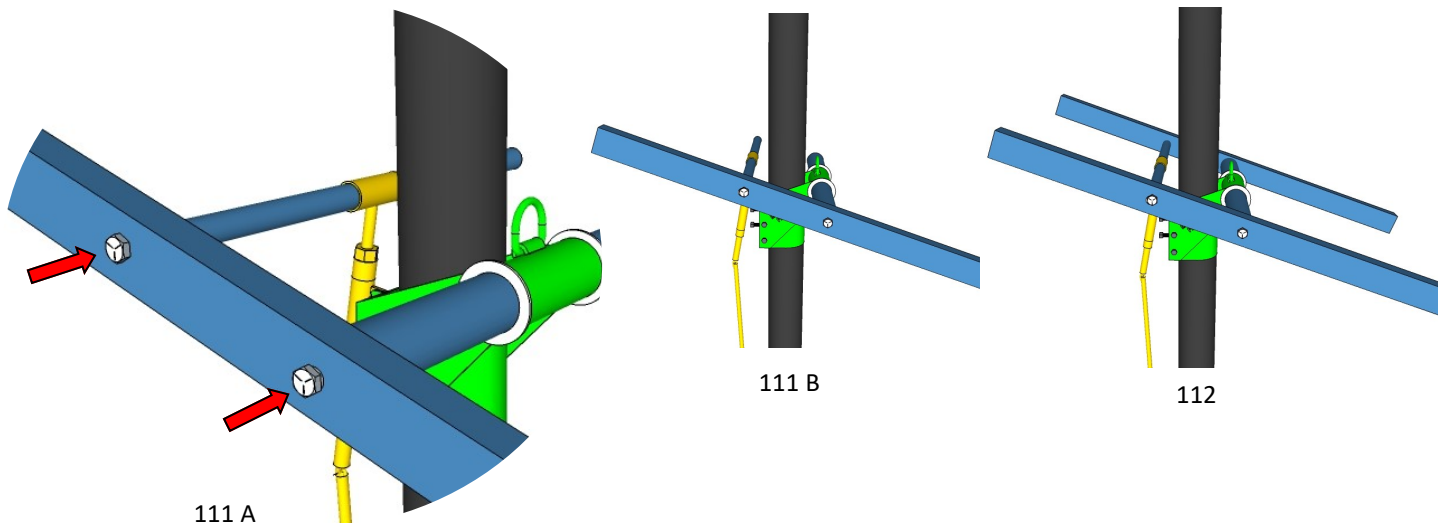

111: Ensure that the MT Solar lettering is upright, and attach one of the 2x3" rectangular tubes to the 2.5" pipe and 2" pipe using the 1/2" x 3 1/2" bolts with 1/2" flat washers and split washers.

112: Install the remaining 2x3" rectangular tube. Snug up all 4 bolts, but leave loose enough to allow for some play when installing Angle pieces. Adjusting the Screw Adjuster as necessary, level the array in preparation for the installation of the 2" x 3" angle.

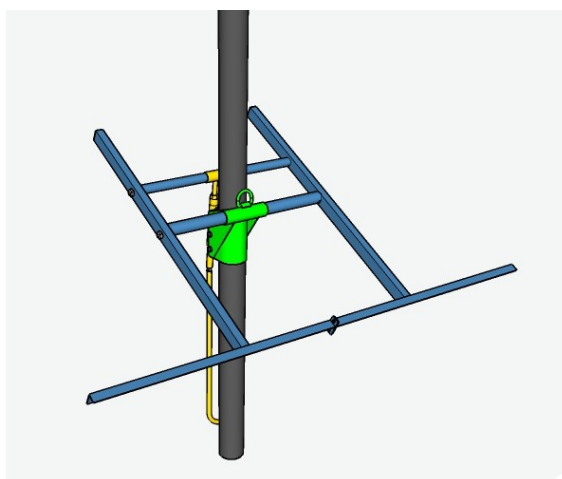

113

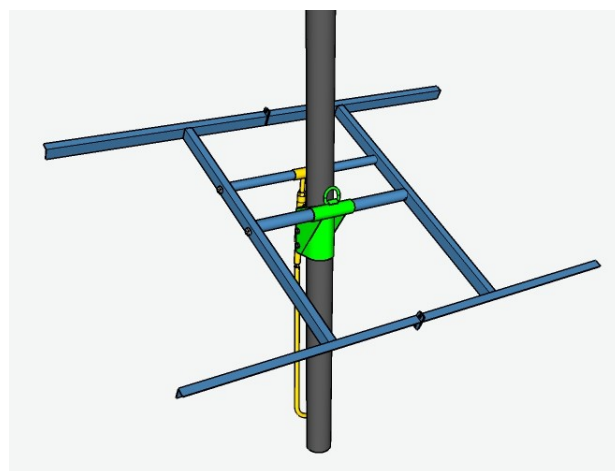

114

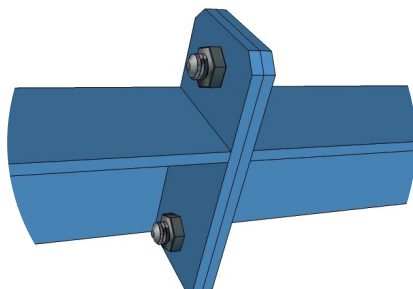

113 B

113: Install the first two 3x2 Angle sections to the 2x3 Tube using the 1/2" x 1 1/2" bolts, flat washers and split washers. Use the 1/2" x 1 1/4" bolts and 1/2" flange nuts to splice the two angle sections together.

114: Install the second two 3x2 Angle sections but DO NOT TIGHTEN at this step.



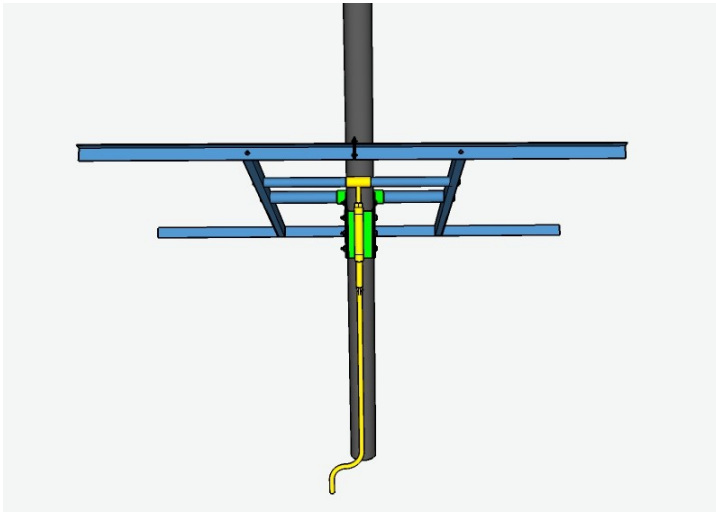

115 A

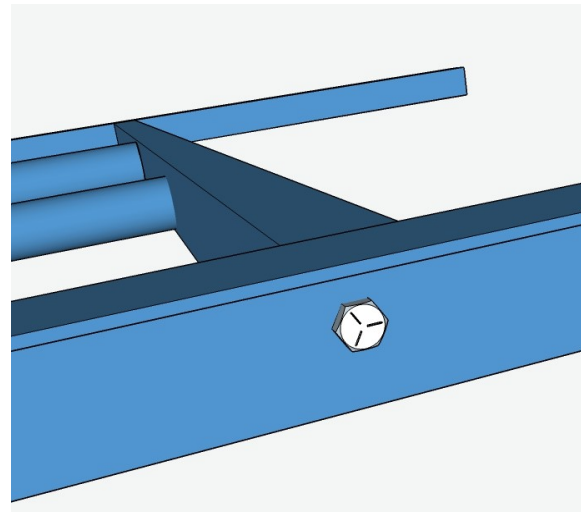

115 B

115: Standing on the North Side of the array with the Tube to Angle bolts started but not tightened, sight the Angle pieces to ensure they are parallel. If not, twist the array until they are then tighten the bolts between the Rectangular Tubes and the Angle.

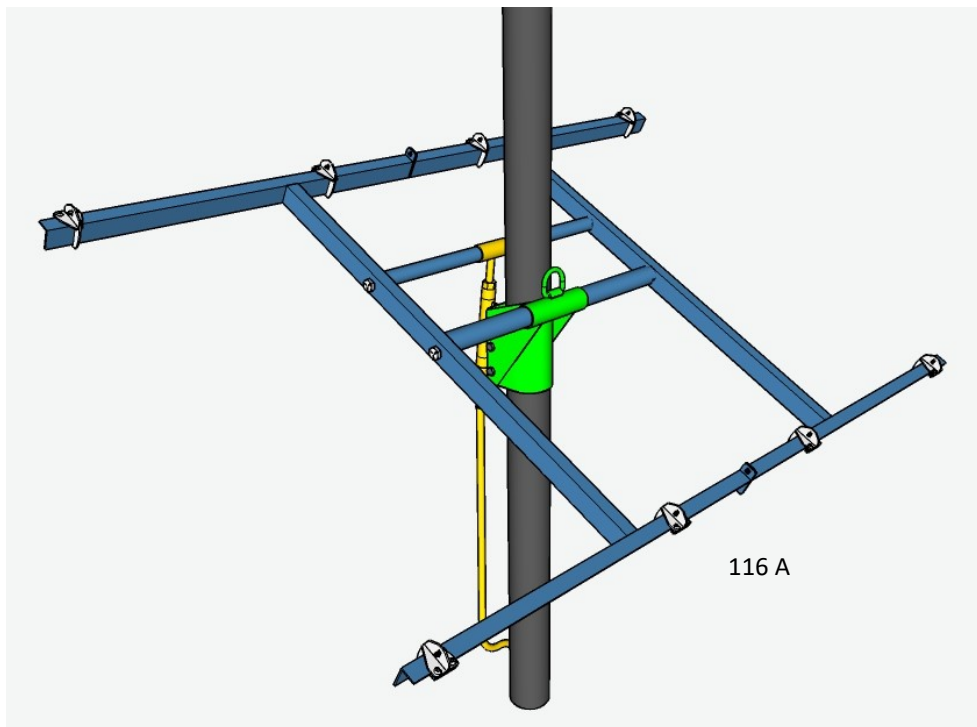

116 A

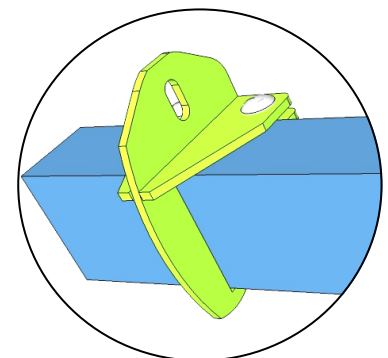

116 B

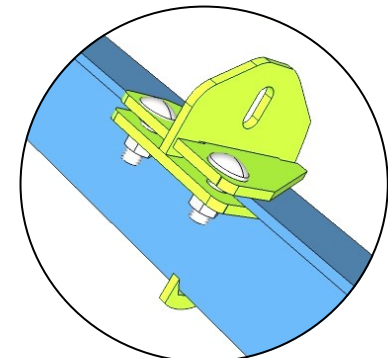

116 C

116: Plan the layout of your rails according to your module width. Install the Beam Clamps on the I-beam using the 3/8" x 1 1/4" carriage bolts and 3/8" flange nuts.

Remember to leave a 7-8" gap in the center to allow for the 6" diameter pipe to protrude through, if you wish to put all the modules on at ground level.



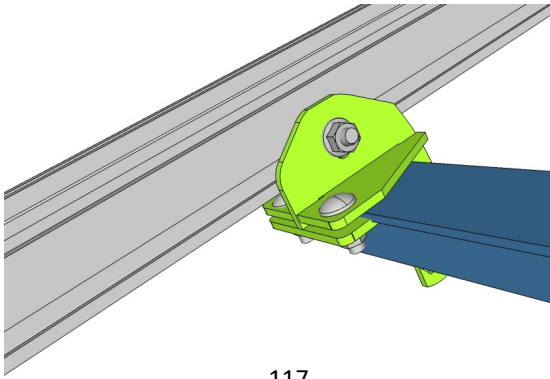

117

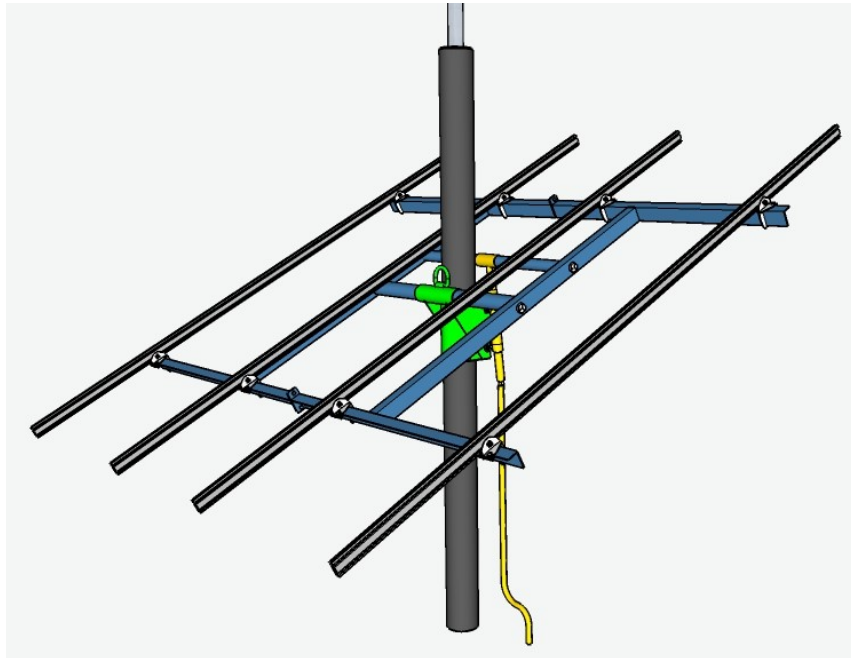

118

117: Install the Mounting Rail into the beam clamps slot as per Mounting Rail instructions. Use 3/8" x 1" **stainless** steel bolts and 3/8" serrated flange nuts. Tighten beam clamps once the rails are in position for modules.

118: Center rails over Angle pieces, keeping equal length of rail off the end of each angle.

119: Install Solar Modules as per Mounting Rail and module manufacturer instructions using top clamps.

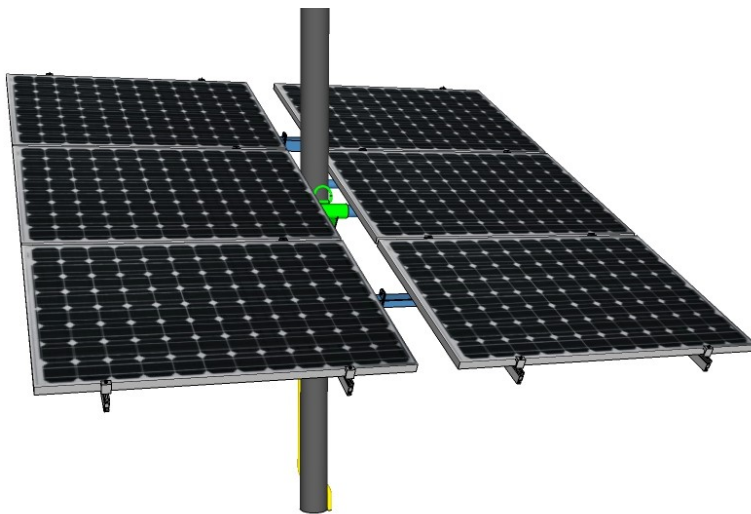

120

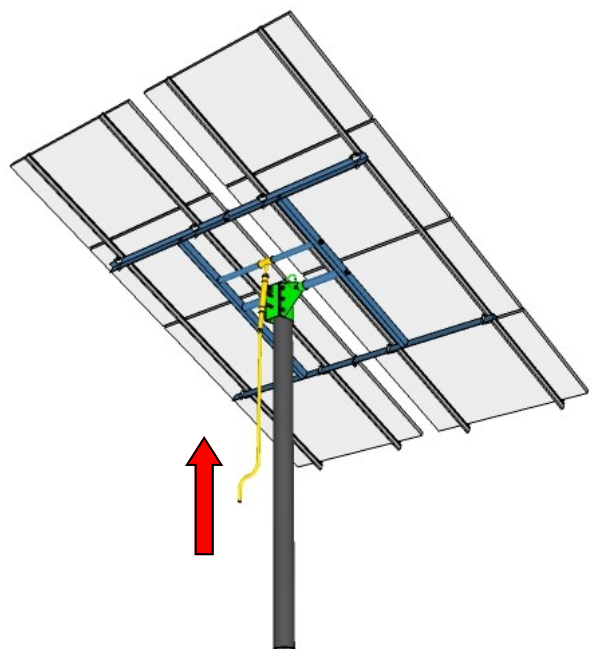

121

120: Once module installation is complete, raise and or tilt the array to facilitate module wiring and wire management as needed.

121: When wiring is completed, raise the array to the top of the pole.

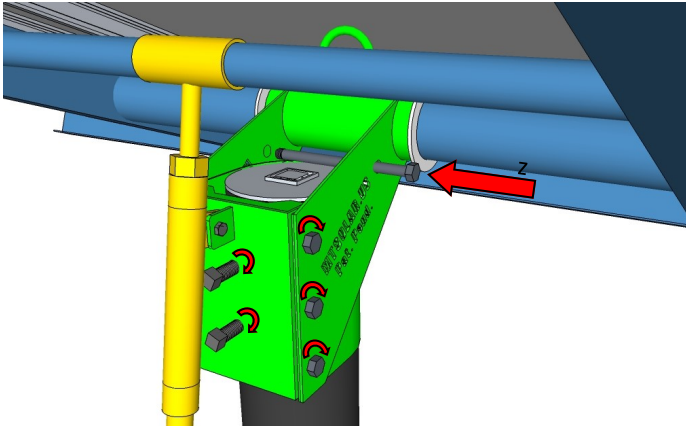

122

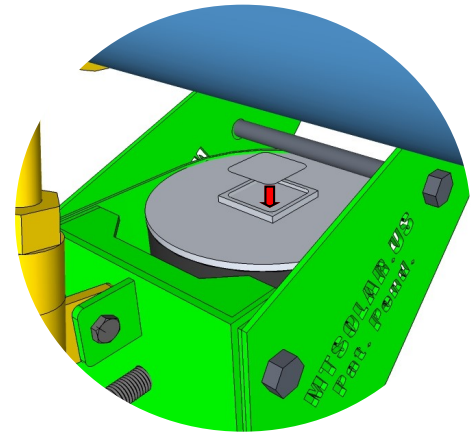

123

122: Insert the last 3/4" x 9" bolt over the top of the pole with the 3/4" flat washers and 3/4" nut. Securely tighten the tension bolts in the back mounting plate to 200 ft-lb and all 3 bolts through the U Bracket Assembly and the back mounting plate.

123: Remove the chain hoist and lifting bracket and place the 2" square cap in place.

124: Attach adjuster handle using the 1/2" x 1" set screw. You may cut the handle to length depending on pole height and site conditions.

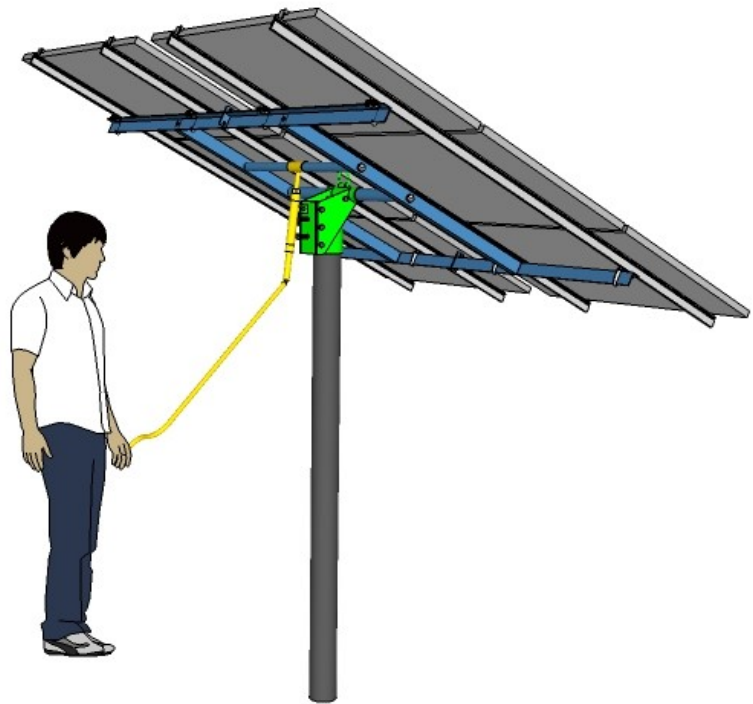

124

Using an angle finder, adjust array to proper tilt.





## THANK YOU FOR CHOOSING MT SOLAR

MT Solar's mission is to provide an exceptional solar installation experience.

We strive to exceed expectations at every turn, from the planning and purchasing process to the final end-user adjustments. We are a customer-service driven company, with a reputation built on the attention and responsiveness given to our customers and their projects.

### ALSO AVAILABLE AT MTSOLAR.US



#### GROUND MOUNT

Cost effective, complete packages



#### APPAREL

Show off your solar installer pride

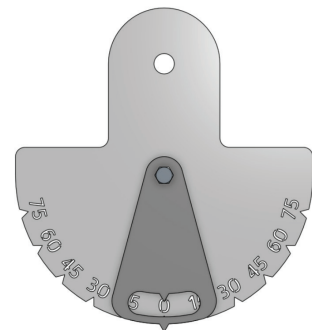

#### TILT-ANGLE INDICATOR

Easy visual for manual tracking

1-844-MT-SOLAR • MTSOLAR.US • P.O. BOX 190, CHARLO, MT 59824

